



Rocam Losi srl
Via Industria 33/35
IT-20080 Albairate (Mi) - Italy
Tel: +39.02.9496.8356 - Fax: +39.02.9496.8341
www.rocam.it

Reg.Imprese 07013680967 Milano
C.F. e P.IVA/VAT number IT07013680967
R.E.A: MI-1929402 Cap.Soc. EUR10.000,00i.v.

Item:

CERVO 1/1
CERVO 2/1
CERVO 3/1



EN

Summary

1. Instruction warnings	2
2. Safety and Right use warnings	2
3. Warranty	2
4. Installation.....	2
4.1 Technical features	3
4.2 Spare parts.....	4
5. Cleaning and Maintenance	5
5.2 Wiring diagram	5
6. Disposal	6

1. Instruction warnings

The user must hold the whole instructions and store up this booklet in case of use. The manufacturer does not assume any responsibility for damages incurred due to the failure of improper use of this manual.

All measures in this manual are expressed in mm.

2. Safety and Right use warnings



This product meets the latest technological evolutions and current safety guidelines.

The stainless-steel food warmers of the line **CERVO** object of this booklet, are projected to be in compliance with directives and field laws in order to guarantee a safe and reliable product.

Any other use will be considered inapposite to the original destination.

Producer do not assume any responsibility for damages caused by an improper use. Responsibility lies only on user.

A proper use also includes compliance with the instructions for use and installation and any additional documentation as well as the conditions of inspection and maintenance.

3. Warranty

Due to commercial and manufacturing requirements, the producer reserves the right to make changes that will improve the use and the quality of its products. The producer in compliance with European Community legislation grants its products for 12 months.

This warranty does not include electrical parts, labour and all replacements related to an improper use of the good. Any manipulation carried out automatically excludes the liability of the manufacturer.

The products or parts to be replaced or repaired for unequivocal defects in workmanship and materials used must be in a "free port" at the offices of the producer, who after a careful inspection, will repair or replace them.

The repairs are carried out exclusively at the headquarters of the manufacturer, and none cost incurred by the customer for repairs will be refunded by the manufacturer unless expressly agreed.

4. Installation



This item is packed and shipped assembled. The manufacturer declines every responsibility of damage of someone or something caused by the failure to comply with the instructions of this manual. Do not make any structural change to the trolley. The elements composing the trolley (plastic, polyurethane foam, bubble wrap, Styrofoam, cardboard, etc.) must be kept away from children as potential sources of danger and must be collected and disposed off separately in accordance with local regulations.

The manufacturer declines every responsibility of damage of someone or something caused by the failure to comply with the instructions of this manual.

After the unpacking process, proceed by removing the adhesive plastic tape before starting up the unit. Any residual glue must be removed carefully (do not use abrasive cleaners).

The device is designed to run on AC to the voltage specified on the technical data plate (located on the bottom of the tank).

The grounding line is marked by the colours yellow/green and must not be interrupted.

The device is provided with a cable in accordance with the CE regulations and with has CE and schuko plug (that can be replaced, when necessary, with a different plug, suitable for the specified wattage and in accordance to the current regulations and guidelines; when necessary, replace the provided cable with a new one with the same features).

Before starting up the appliance:

- Check if the electrical system can withstand the appliance's load (WATT as indicated on the technical plate);
- Make sure that the electrical system is provided with ground connection according to the current norms and guidelines;
- Connect the appliance to the ground network of the system through a cable to be connected to the corresponding screw placed on the outer casing of the unit itself.

First use of the appliance:



The first use of the appliance may give off unpleasant smells and smoke, this is due to the fat residues.

FOR THE FIRST USE IT IS RECOMMENDED TO TURN ON THE UNIT WITHOUT FOOD INSIDE and with water only so that the residues can be eliminated. Warning: the water must cover completely the heating element placed inside the tank.

WARNING:



Once the appliance is switched on, the selected temperature will be reached in a short time. In order to avoid any inconvenience, switch on the unit only when the service is about to begin and turn it off right after the end. Do not make any structural change to the unit.

4.1 Technical features

	CERVO 1/1	CERVO 2/1	CERVO 3/1
<i>Heating element</i>	2000 W	2000 W	2000 W
<i>Power supply</i>	230 V		
<i>Temperature Range *</i>	30-90°C		
<i>Tank capacity</i>	1 x GN 1/1-200	2 x GN 1/1-200	3 x GN 1/1-200

Weight (Kg)	12	17	21
--------------------	----	----	----

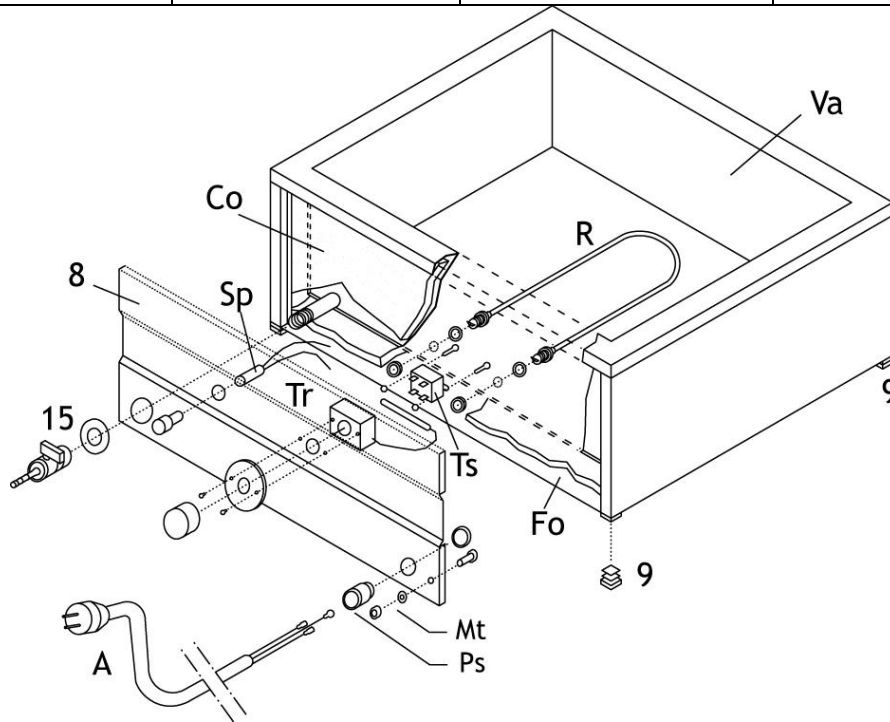

WARNING: The appliance works through a bain marie process and the water inside the tanked is warmed up by a heating element. In order to avoid any damage to the heating element itself do never use the appliance without water inside the tank (the maximum water level is indicated by a notch).

ANY MANIPULATION AUTOMATICALLY EXCLUDES THE MANUFACTURER RESPONSABILITY MAKING THE WARRANTY VOID.

4.2 Spare parts

Ref.	CERVO	1/1	2/1	3/1	Description
	Code	Quantity			
Va		1	1	1	Tank
Co		1	1	1	Insulating material
A	D0500CAVO	1	1	1	Power cable
Fo		1	1	1	Bottom
R	D04INR2000	1	1	1	Heating element 2000W
Ts	D0300TESIC	1	1	1	Safety Thermostat
Sp	D0500SPIATC	1	1	1	Operation light
Tr	D0300TE3090	1	1	1	Thermostat 30-90°

Mt		1	1	1	Ground terminal
Ps	D0500PRESCA	1	1	1	Cable gland
8		1	1	1	Control panel
9	E01PLCOPQ20	4	4	4	Rubber foot
15	D0100RUB3/8	1	1	1	Drain tap

5. Cleaning and Maintenance

WARNING:



Before any cleaning operation unplug the device from the electrical system. Never wash the appliance with water jets in order to prevent water seepage inside the electrical components



Before any cleaning operation wait for the appliance to be cooled down (wait at least one hour from the end of the service).

The thermic trolley should be cleaned with specific cleansers for stainless steel and the chromed parts with alcohol or specific cleansers for chrome finish. In any case do not use abrasive products.

The trolley is supplied with a safety thermostat set to 150°C, which works in case of malfunction of the electronic thermostat. To reset the system following an interruption due to the safety thermostat, unscrew the control panel and push the red button on it.

5.1 Breakdowns

Problem	Possible cause	Solution
The appliance does not heat up	Power cut	Check the power presence in the electricity network.
	The heating element is burned	Contact the retailer
	The thermostat is broken	Contact the retailer
	The power switch is broken	Contact the retailer
	The power cable is worned-out	Replace the cable with a new one with the same technical features

5.2 Wiring diagram

Code	Description
TS	Safety thermostat
TH	Thermostat 30-90°C
SP	Warning light

RES	Heating element
-----	-----------------

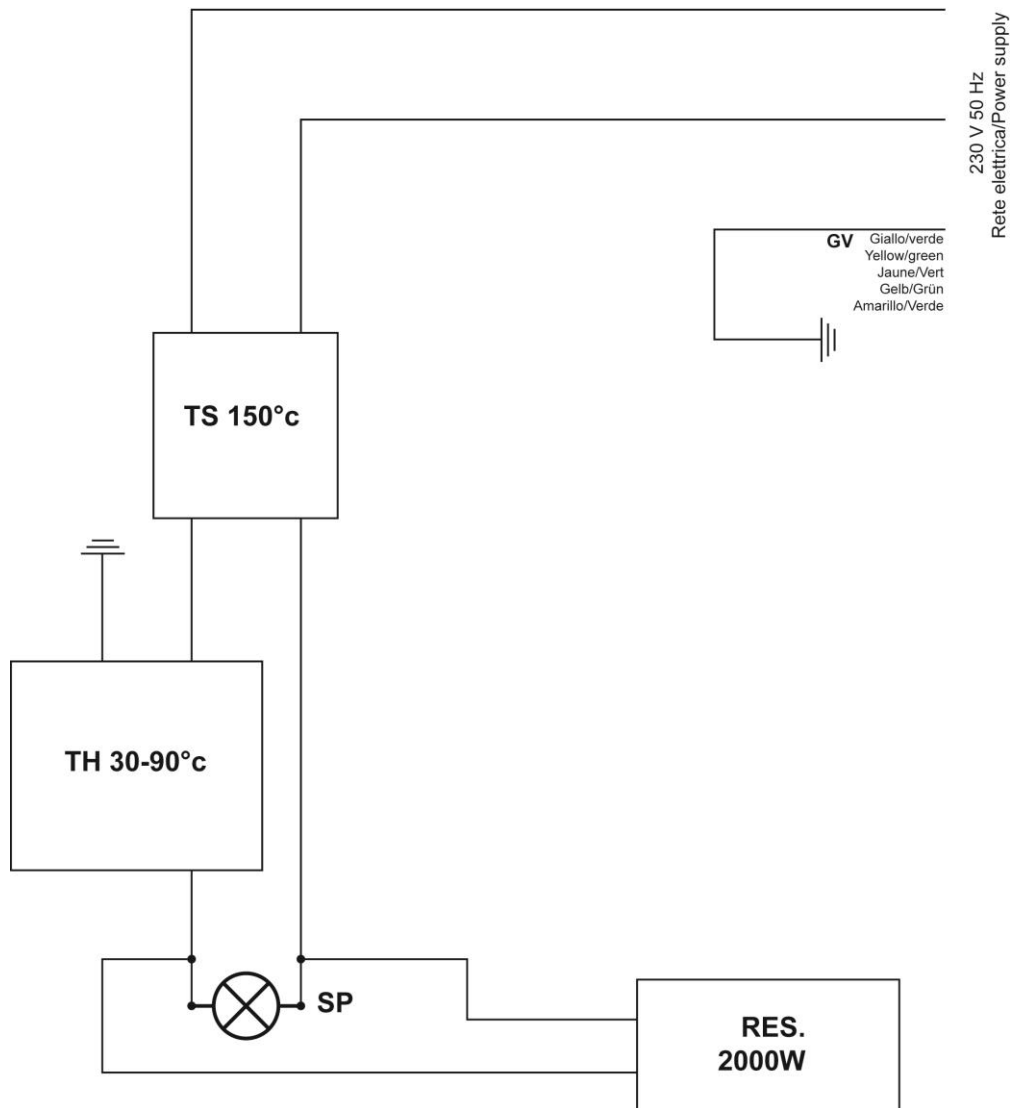

6. Disposal



At the end of its life cycle, the device must be disposed according to the current regulations and must, where possible, be disassembled and disposed according to the nature of its various components. The packing materials (plastic, foam, bubble wrap, styrofoam, cardboard etc) must be kept away from children as potential sources of danger and must be collected and disposed separately in accordance with the local regulations. This marking shown on the product or its literature, indicates that it should not be disposed with other household wastes at the end of its working life. To prevent possible harm to the environment or human health from uncontrolled waste disposal, please separate this from other types of wastes and recycle it responsibly to promote the sustainable reuse of material resources. Household users should contact either the retailer where they purchased this product, or their local government office, for details of where and how they can take this item for environmentally safe recycling.